

**STAGE 31**

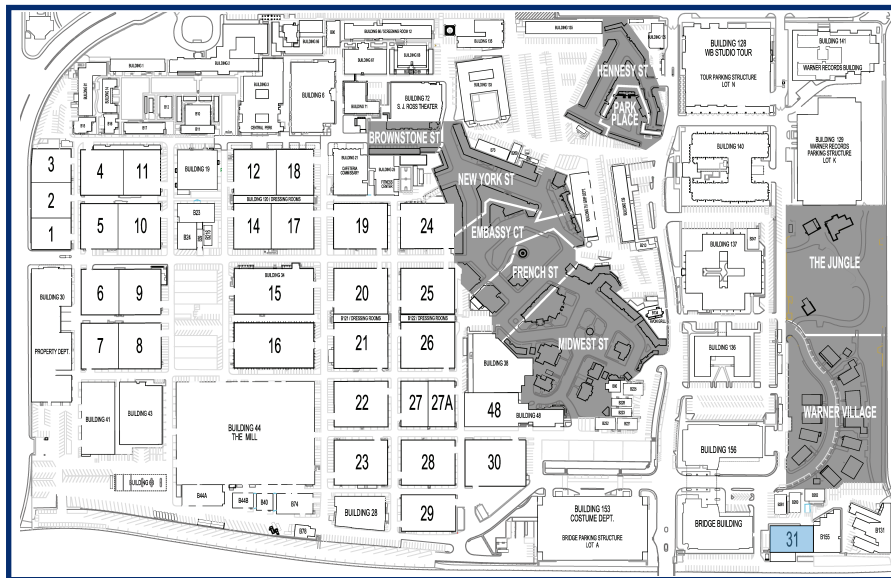
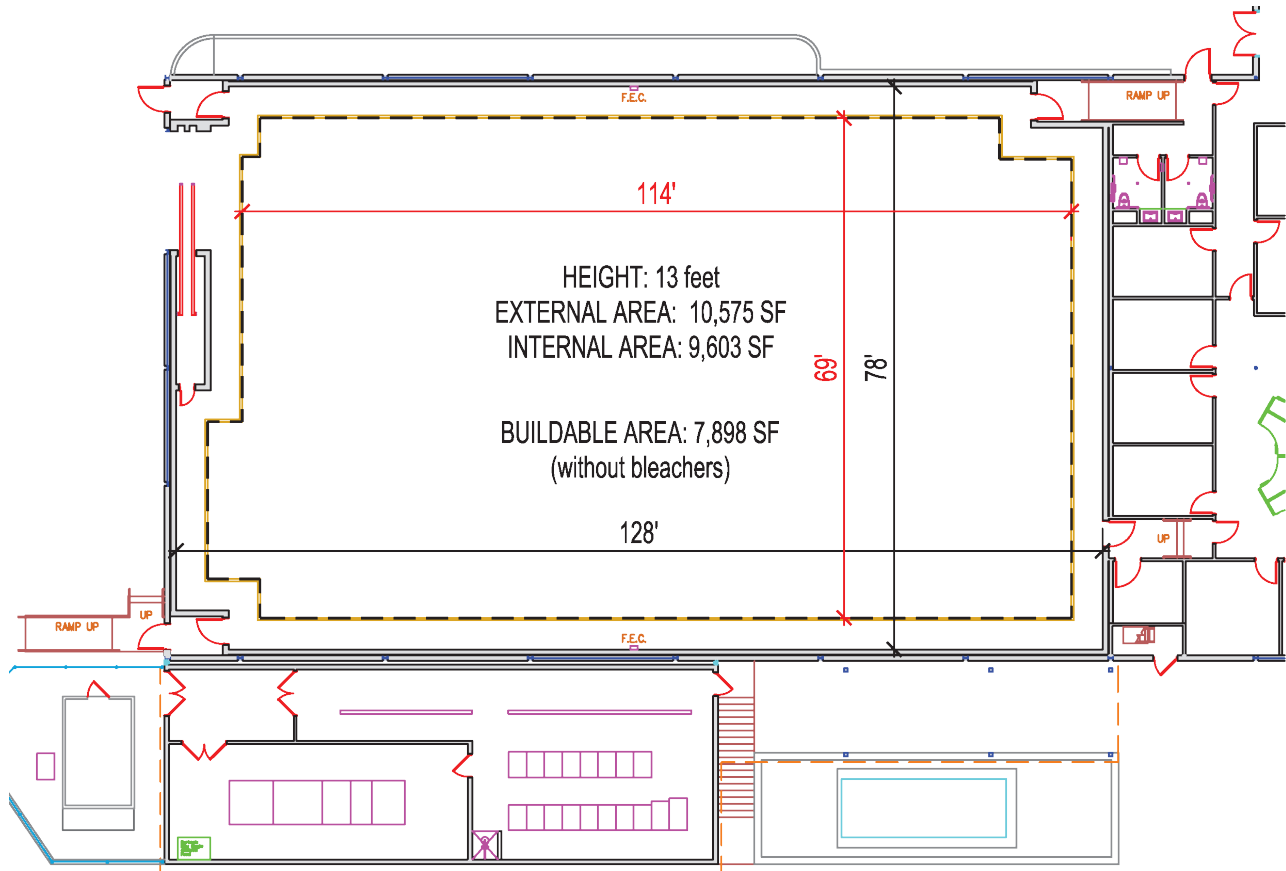

## STAGE 31

### MEASUREMENTS

Stage Height	13'
Square Ft.	10,575 SF
Dimensions	128' x 78'
Buildable Area	7,898 SF
Elephant Door Dimensions (West)	15' x 11'6"

### UTILITIES

Air Conditioning	Central
Heat	Yes
Power	4800 amps / 3 phase
Internet	Internet and Fiber available

### SUPPORT SPACE

Int. Dressing Rooms w/ Restrooms	None
Gold Rooms	None
Sound Booth	None
Dimmer Room – Upper Catwalks	None

### WEIGHT RESTRICTIONS - STAGE FLOOR

Multi-Layer Sub Floor w/ Cresform Surface	High density particle board atop (2) layers plywood atop concrete slab
Temporary Load Capacity	250 PSF
Max Gross Vehicle Weight (GVW) – Buildable Floor Area	30,000 lbs. (7,500 per wheel)
Max (GVW) – Interior Perimeter	30,000 lbs. (7,500 per wheel)
Max (GVW) – Truck Loading Zone	30,000 lbs (7,500 per wheel)

- Please contact OPS at 818-954-6777 and Safety & Environmental Affairs at 818-954-2890 to discuss any weight load questions or concerns.
- Engineering approval required for any unusual load requirements on roof trusses or permanent beams.
- Fall Protection is mandatory whenever working beyond the catwalk or guardrail in the “ozone”.